

**Extra
Hard**

Torx® Drive

Insert Bits

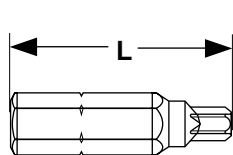

INSERT BIT

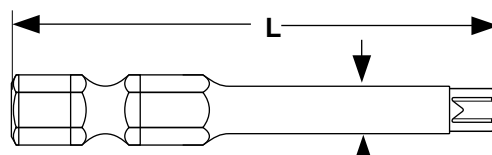
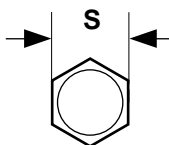
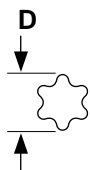

POWER BIT

TORX®-Alternative INSERT BITS • EXTRA HARD						Magna™, Apex®**	
Part Numbers			S	Drive Size	D	L	
Kanebridge	Apex®	Magna™	Shank (A.F.)		Point Width	Overall Length	
37-153	440-TX-08	37153	1/4	T8	.090	1	
37-155	440-TX-09	37155	1/4	T9	.097	1	
37-157	440-TX-10	37157	1/4	T10	.107	1	
37-159	440-TX-15	37159	1/4	T15	.128	1	
37-161	440-TX-20	37161	1/4	T20	.151	1	
37-163	440-TX-25	37163	1/4	T25	.173	1	
37-165	440-TX-27	37165	1/4	T27	.195	1	
37-167	440-TX-30	37167	1/4	T30	.216	1	
37-169	440-TX-40	37169	1/4	T40	.260	1	

TORX®-Alternative POWER BITS • EXTRA HARD						Magna™, Apex®**		
Part Numbers			S	Drive Size	D	B		L
Kanebridge	Apex®	Magna™	Shank (A.F.)		Point Width	Body Diameter		
						Max	Min	Overall Length
37-713	49-TX-08	37713	1/4	T8	.090	.125	.115	1-15/16
39-933	49-TX-09	39933	1/4	T9	.097	.125	.115	1-15/16
37-715	49-TX-10	37715	1/4	T10	.107	.156	.146	1-15/16
37-717	49-TX-15	37717	1/4	T15	.128	.156	.146	1-15/16
37-719	49-TX-20	37719	1/4	T20	.151	.187	.177	1-15/16
37-721	49-TX-25	37721	1/4	T25	.173	.187	.177	1-15/16
37-723	49-TX-27	37723	1/4	T27	.195	.250	.240	1-15/16
37-725	49-TX-30	37725	1/4	T30	.216	.250	.240	1-15/16
37-727	49-TX-40	37727	1/4	T40	.280	.315	.296	1-15/16

*Bits meet the same dimensions as those published by the manufacturers of the Apex® and Magna™ brands.

Applications/ Advantages	Torx®-alternative bits offer a positive-engaging, fast-locating method of transmitting torque and optimizing worker efficiency. The positive torque control adds to the bit's drive life. Power bits are used with power drivers. Insert bits are ideal for use with hand drivers, or may be used in power drivers when attached to a bit holder. Extra hard bits are used specifically with case hardened screws.
Material	Chrome vanadium tool steel
Hardness	Rockwell C 59 - 62.

®Apex is a registered trademark of Cooper Industries.

™Magna is a division of Vermont American Corporation.

®Torx is a registered trademark of the Camcar Corporation, division of Textron Industries.

Kanebridge's insert and power bits are not manufactured by or connected with the producers of Apex® or Magna™ bits.