

# Machine Screws

# Head Dimensions

82° Flat  
100° Flat

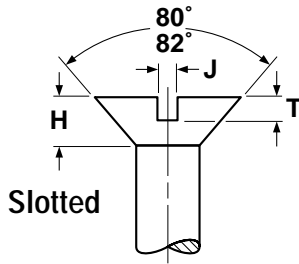

Slotted

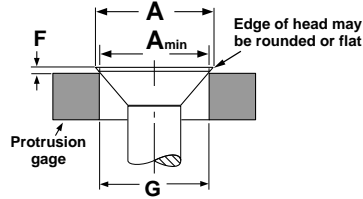

Protrusion gage

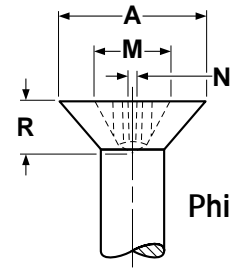

Phillips

## FLAT HEADS FOR MACHINE SCREWS

ASME B18.6.3-1998

| Nominal Size | A               |      | H               |      | J               |      | T                 |      | M                 | R     | N                                | F    |                 | G    | Phillips Driver Size |
|--------------|-----------------|------|-----------------|------|-----------------|------|-------------------|------|-------------------|-------|----------------------------------|------|-----------------|------|----------------------|
|              | Head Dimensions |      | Slot Dimensions |      | Slot Dimensions |      | Recess Dimensions |      | Recess Dimensions |       | Protrusion Above Gaging Diameter |      | Gaging Diameter |      |                      |
|              | Diameter        |      | Height          |      | Width           |      | Depth             |      | Diam.             | Depth | Width                            | Max  |                 | Min  |                      |
|              | Max             | Min  | Max             | Min  | Max             | Min  | Max               | Min  | Ref               | Ref   | Ref                              | Max  | Min             |      |                      |
| 0            | .112            | .096 | .035            | .026 | .023            | .016 | .015              | .010 | .062              | .035  | .014                             | .026 | .016            | .078 | 0                    |
| 1            | .137            | .120 | .043            | .033 | .026            | .019 | .019              | .012 | .070              | .043  | .015                             | .028 | .016            | .101 | 0                    |
| 2            | .162            | .144 | .051            | .040 | .031            | .023 | .023              | .015 | .096              | .055  | .017                             | .029 | .017            | .124 | 1                    |
| 3            | .187            | .167 | .059            | .047 | .035            | .027 | .027              | .017 | .100              | .060  | .018                             | .031 | .018            | .148 | 1                    |
| 4            | .212            | .191 | .067            | .055 | .039            | .031 | .030              | .020 | .122              | .081  | .018                             | .032 | .019            | .172 | 1                    |
| 5            | .237            | .215 | .075            | .062 | .043            | .035 | .034              | .022 | .148              | .074  | .027                             | .034 | .020            | .196 | 2                    |
| 6            | .262            | .238 | .083            | .069 | .048            | .039 | .038              | .024 | .168              | .094  | .029                             | .036 | .021            | .220 | 2                    |
| 8            | .312            | .285 | .100            | .084 | .054            | .045 | .045              | .029 | .182              | .110  | .030                             | .039 | .023            | .267 | 2                    |
| 10           | .362            | .333 | .116            | .098 | .060            | .050 | .053              | .034 | .198              | .124  | .032                             | .042 | .025            | .313 | 2                    |
| 12           | .412            | .380 | .132            | .112 | .067            | .056 | .060              | .039 | .262              | .144  | .035                             | .045 | .027            | .362 | 3                    |
| 1/4          | .477            | .442 | .153            | .131 | .075            | .064 | .070              | .046 | .276              | .160  | .036                             | .050 | .029            | .424 | 3                    |
| 5/16         | .597            | .556 | .191            | .165 | .084            | .072 | .088              | .058 | .358              | .205  | .061                             | .057 | .034            | .539 | 4                    |
| 3/8          | .717            | .670 | .230            | .200 | .094            | .081 | .106              | .070 | .386              | .234  | .065                             | .065 | .039            | .653 | 4                    |
| 1/2          | .815            | .765 | .223            | .186 | .106            | .091 | .103              | .065 | .418              | .265  | .069                             | .081 | .049            | .739 | 4                    |

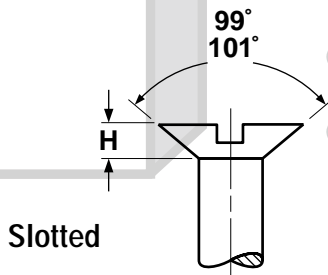

Slotted

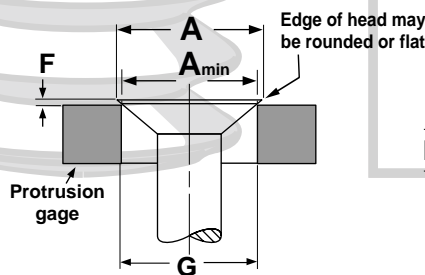

Protrusion gage

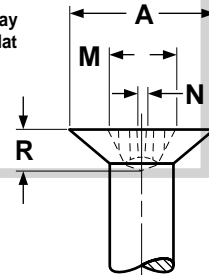

Phillips

## FLAT HEAD 100° FOR MACHINE SCREWS

ASME B18.6.3-1998

| Nominal Size | A               |      | H               |      | J               |      | T                 |      | M                 | R     | N                                | F    |                 | G    | Phillips Driver Size |
|--------------|-----------------|------|-----------------|------|-----------------|------|-------------------|------|-------------------|-------|----------------------------------|------|-----------------|------|----------------------|
|              | Head Dimensions |      | Slot Dimensions |      | Slot Dimensions |      | Recess Dimensions |      | Recess Dimensions |       | Protrusion Above Gaging Diameter |      | Gaging Diameter |      |                      |
|              | Diameter        |      | Height          |      | Width           |      | Depth             |      | Diam.             | Depth | Width                            | Max  |                 | Min  |                      |
|              | Max             | Min  | Max             | Min  | Max             | Min  | Max               | Min  | Ref               | Ref   | Ref                              | Max  | Min             |      |                      |
| 0            | .112            | .095 | .026            | .019 | .023            | .016 | .013              | .008 | .054              | .027  | .013                             | .020 | .012            | .074 | 0                    |
| 2            | .162            | .142 | .037            | .029 | .031            | .023 | .019              | .012 | .088              | .048  | .012                             | .022 | .014            | .121 | 1                    |
| 4            | .212            | .188 | .049            | .039 | .039            | .031 | .024              | .017 | .110              | .070  | .018                             | .025 | .016            | .167 | 1                    |
| 6            | .262            | .235 | .060            | .049 | .048            | .039 | .030              | .022 | .148              | .074  | .027                             | .028 | .017            | .214 | 2                    |
| 8            | .312            | .282 | .072            | .060 | .054            | .045 | .036              | .027 | .162              | .090  | .028                             | .031 | .019            | .261 | 2                    |
| 10           | .362            | .329 | .083            | .070 | .060            | .050 | .042              | .031 | .178              | .104  | .030                             | .034 | .021            | .307 | 2                    |
| 1/4          | .477            | .437 | .110            | .094 | .075            | .064 | .055              | .042 | .240              | .124  | .033                             | .040 | .025            | .415 | 3                    |