

150° Countersunk Flat Head

Semi-tubular Rivets

Rivets

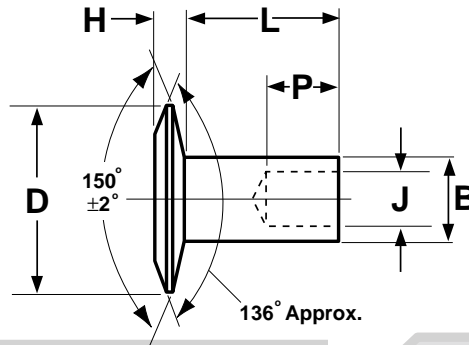

SEMI-TUBULAR RIVETS, 150° COUNTERSUNK HEAD

ANSI/ASME B18.7

| Nominal Size | B | | D | | | | H | | | | J | | P | Tolerance on Length | | |
|--------------|----------------|-------|---------------|-------|------------|-------|----------------|-------|------------|-------|---------------------------|-------|-----------------------------|--|--|-------------------------|
| | Shank Diameter | | Head Diameter | | | | Head Thickness | | | | Hole Dia. at End of Rivet | | Hole Depth to Start of Apex | Up to and including 4 times shank dia. | Over 4 times shank dia. and up to and including 8 times shank dia. | Over 8 times shank dia. |
| | | | Standard Head | | Large Head | | Standard Head | | Large Head | | | | | | | |
| | Max | Min | Max | Min | Max | Min | Max | Min | Max | Min | Max | Min | Ref | | | |
| 0.146 | 0.146 | 0.141 | 0.303 | 0.289 | 0.367 | 0.351 | 0.045 | 0.035 | 0.051 | 0.041 | 0.105 | 0.099 | 0.141 | ±0.010 | 0.012 | 0.015 |
| 0.188 | 0.188 | 0.182 | 0.367 | 0.351 | 0.478 | 0.458 | 0.051 | 0.041 | 0.067 | 0.053 | 0.139 | 0.133 | 0.188 | ±0.010 | ±0.012 | ±0.015 |
| 0.252 | 0.252 | 0.244 | 0.478 | 0.458 | | | 0.067 | 0.053 | | | 0.183 | 0.173 | 0.250 | ±0.010 | ±0.015 | ±0.020 |

| | |
|---------------------------------|---|
| Description | A small, headed metal fastener having a coaxial cylindrical or tapered hole which does not exceed 112% of the mean shank diameter in the end opposite the head. The rivet's head is countersunk at an angle of 150° and has a low-profile that protrudes slightly above the material to which the rivet is attached. |
| Applications/ Advantages | Easier to clinch than solid rivets. The hole reduces riveting forces for riveting tooling while the remaining clinched solid shank can provide comparable shear strengths to other common riveting products. The 150° countersunk head is often chosen for decorative purposes. The fastener is installed with a riveting hammer. |
| Material | Steel: Low carbon steel (containing 0.1% carbon or less) Aluminum: Grades 5056, 1100, 2017, 2117 or 6053 |